

A-8747 WALL MOUNT FAUCET

BEFORE YOU BEGIN:

We recommend consulting a professional if you are unfamiliar with installing plumbing fixtures. We accept no liability for any damage to the faucet, plumbing, sink, counter top, to personal injury during the installation.

HELPFUL TOOLS:

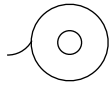

Teflon Tape



Adjustable Wrench



Level



Hex Wrench



Thread Sealant



Pipe Clamps

NOTICE:

1. Shut off the main water supply where the new faucet is being installed.

INSTALLATION:

1. Prepare for installation by installing wood blocking between the two studs where the faucet will mount.
2. Assemble the valve body. Connect the valve to the provided pipe nipple, and elbow as well. Apply teflon tape or thread sealant to each threaded connection.

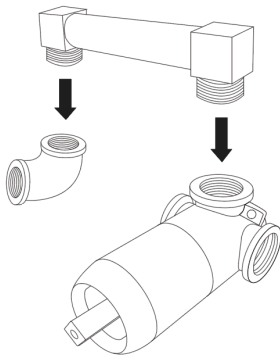

3. Mount the valve body in its prepared location. Attach the valve to the wood blocking using pipe clamps. Use a level to ensure that the valve is mounted straight. Attach your existing water line to the valve. Apply thread sealant or teflon tape to the threaded connections. Use any necessary piping and adapters that are needed (not provided).

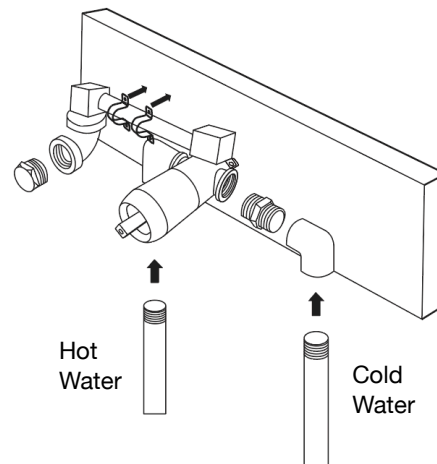

A-8747 WALL MOUNT FAUCET

3. Remove the protective sheath from the valve and install the decorative escutcheon. Tighten the fixing ring with the hex wrench.

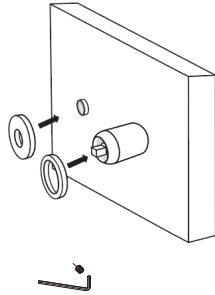

4. Attach the spout to the valve by threading it into its outlet. Apply teflon tape or thread sealant to the threads before attaching.

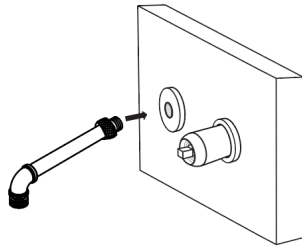

5. Attach the handle by sliding it onto the valve stem. Tighten the screw to secure.

6. Once the installation is complete, turn on the main water supply. Remove the aerator from the spout. Turn the water on to allow any dust or loose sediment to clear the system. Allow the water to flow through the spout for approximately 60 seconds, and verify that hot and cold water are running properly. Reattach the aerator once testing is complete.

CARE and CLEANING:

- Use a mild and soft detergent such as warm water for cleaning. Do not use abrasive cleaners that may scratch or dull the faucet vibrant surface.
- Do not allow cleaner to sit or soak on the surface or the spot will be appeared after a while.
- Clean and rinse with water immediately after cleaner application.
- Use a soft sponge or cloth. Do not use an abrasive material such as blush or scouting pad to clean the faucet surface.